

TECHNICAL DATA

H x W x D	mm	kg	V AC/DC	mA AC/DC	2	V/A	2	1010	IP
120 x 76 x 26 mm		0,51 kg	12/24V AC/DC	50/40 mA 80/40 mA	מסמרים 2	30V DC - 2 A 125V AC - 1 A	לחצני יציאה 2	משתמשים 1010 מסמרים 1000 = 1 מסמרים 10 = 2	55*
AC230SADKJ	Hz							0 - 99 s	
	125 KHz (MARIN)							-10+60°C	

3 מצבי פעולה:
- כניסה עם קורא קרבה בלבד
- כניסה עם קרבה או קוד
- כניסה עם קרבה + קוד (מצב זה יחייב שלכל משתמש יהיה כרטיס וסיסמא)

*IP 55 - Protection against dust, no damaging deposits. Protection against low pressure water jets from any direction.

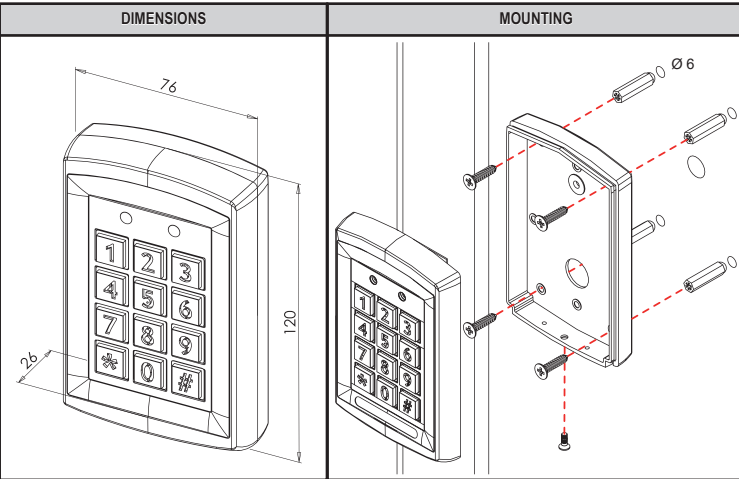

ATTENTION : Make sure to observe correct polarity and input voltage: 12/24V AC/DC as specified!

Read carefully this user guide before activating and using. Use this equipment only for an adapted application. The manufacturer cannot be held responsible for possible damage caused when usual security requirements are not fulfilled. Mounting, maintenance and repair must be carried out by a skilled and authorized staff. The commissioning is easy, but a correct handling and an appropriate maintenance are mandatory to keep the device working perfectly.



CONNECTION

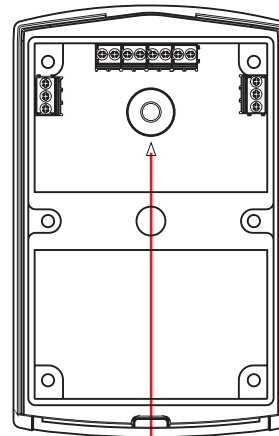

Anti-tamper photocell. To activate the function, please refer to page 16 "Anti-tamper function"

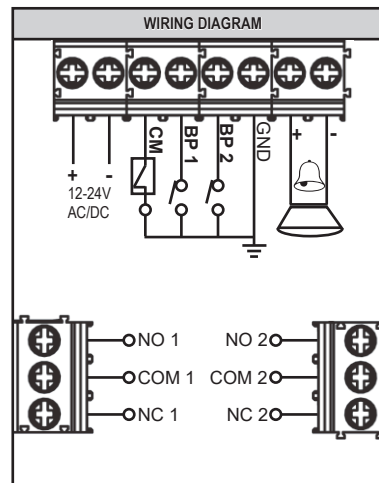

- BP 1**
= Exit Button Relay 1
- BP 2**
= Exit Button Relay 2
- CM**
= Door magnet*
- = Bell*
- * Please refer to Bell function on page 16/24
- = 1 mm²

*Door magnet = Detection of door status. When someone opens the door and comes in, the door is closed. The system will automatically detect the door status and lock the door, even though there is still a delay period.

EXAMPLES FOR TYPICAL WIRING CONFIGURATIONS

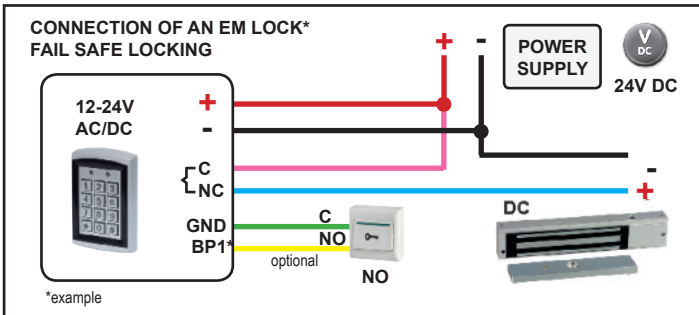
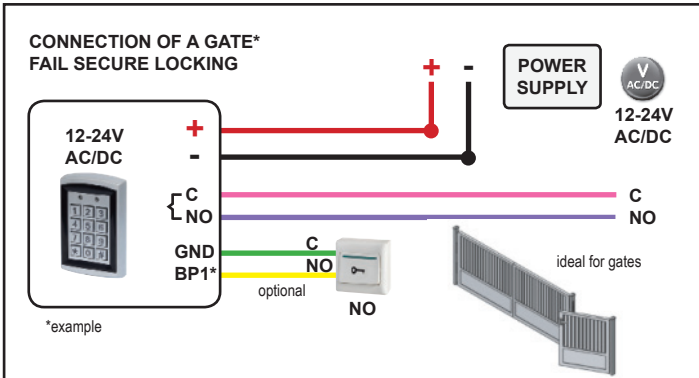
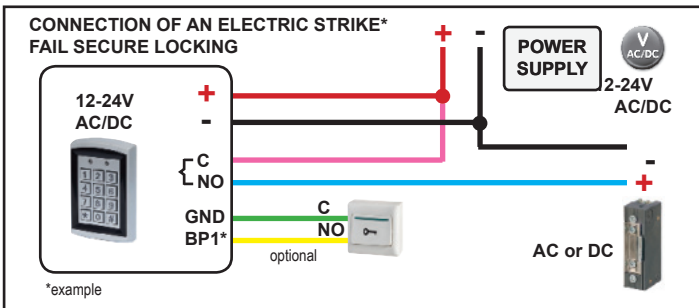

SETTING MODE

Changing number of digits (codes)	
Attention: this modification must be done before the first programming of a code (factory setting = 4 digits)	
Enter the master code 2 X (Default code is 1234)	long BEEP + right LED will turn yellow
Enter * 904	short BEEP + right LED will turn yellow
Enter the digits (X is from 2 to 6)	long BEEP + right LED will turn yellow
Changing digit number erases all previous records!	
If X = 2 the master code is 12	If X = 5 the master code is 12345
If X = 3 the master code is 123	If X = 6 the master code is 123456
If X = 4 the master code is 1234	
Enter # #	right LED will turn green
Create a master card	
The master card allows to open the setup session	
Enter the master code 2 X (Default code is 1234)	long BEEP + right LED will turn yellow
Enter * 7	right LED will flash green
Swipe the master card 1 X	long BEEP + right LED will turn yellow
Enter # #	right LED will turn green
Changing a master card	
Enter the master code 2 X or swipe the master card 1 X (Default code is 1234)	long BEEP + right LED will turn yellow
Enter * 7	right LED will turn red
Enter **	right LED will flash green
Swipe the master card 1 X	long BEEP + right LED will turn yellow
Enter # #	right LED will turn green
Changing a master code	
It is recommended to modify the master code which allows to open the setup session for security reasons. The user codes must be different from mastercode.	
Enter the master code 2 X or swipe the master card 1 X (Default code is 1234)	long BEEP + right LED will turn yellow
Enter * 3	right LED will flash yellow
Enter the new code 2 X	long BEEP + right LED will turn yellow
Enter # #	right LED will turn green
How to restore the default master code (1234)	
(in case of lost or forgotten master code)	
Switch off the power supply from the keypad	all LEDs light off
Press # key. Keep it pressed for 3 seconds while powering the device again	short BEEP + right LED will turn green